



AR-EN Ltd.

from manufacturer to export

Address:Ahmetpasa cad.Kalender is Merkezi no:41 Kayseri/TURKIYE

Mobile phone:+90 533 659 50 39

YENİ PASLANMAZ ÇELİK MERDİVENLER *STAINLESS STEEL LADDERS*



Standart / *Standard*



AISI 304

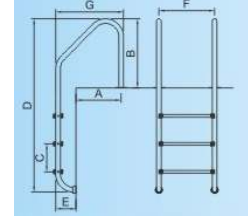

 Cod.

- ◉ 2 MRS-002
- ◉ 3 MRS-003
- ◉ 4 MRS-004
- ◉ 5 MRS-005

	a	b	c	d	e	f	g
◉ 2 MRS-002	460	620	250	1300	180	500	640
◉ 3 MRS-003	460	620	250	1550	180	500	640
◉ 4 MRS-004	460	620	250	1800	180	500	640
◉ 5 MRS-005	460	620	250	2050	180	500	640

Ölçüler mm - *Measures in mm*
D43x1,2 mm



Muro / *Muro*



AISI 304

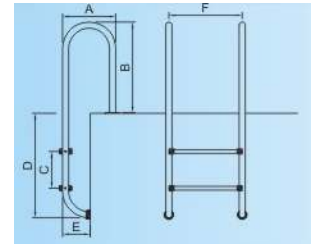

 Cod.

- ◉ 2 MRM-002
- ◉ 3 MRM-003
- ◉ 4 MRM-004
- ◉ 5 MRM-005

	a	b	c	d	e	f
◉ 2 MRM-002	350	620	250	710	180	500
◉ 3 MRM-003	350	620	250	960	180	500
◉ 4 MRM-004	350	620	250	1210	180	500
◉ 5 MRM-005	350	620	250	1460	180	500

Ölçüler mm - *Measures in mm*
D43x1,2 mm



YENİ PASLANMAZ ÇELİK MERDİVENLER *STAINLESS STEEL LADDERS*



Standart / *Standard*



AISI 304

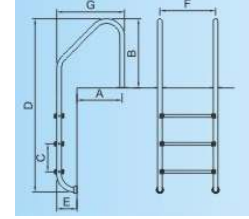

	Cod.	a	b	c	d	e	f	g
◉	2 MRS-002	460	620	250	1300	180	500	640
◉	3 MRS-003	460	620	250	1550	180	500	640
◉	4 MRS-004	460	620	250	1800	180	500	640
◉	5 MRS-005	460	620	250	2050	180	500	640

Ölçüler mm - *Measures in mm*
D43x1,2 mm



Muro / *Muro*



AISI 304

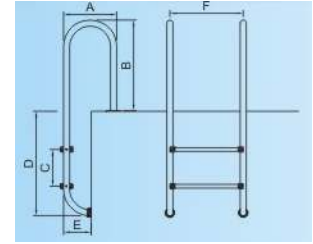

	Cod.	a	b	c	d	e	f
◉	2 MRM-002	350	620	250	710	180	500
◉	3 MRM-003	350	620	250	960	180	500
◉	4 MRM-004	350	620	250	1210	180	500
◉	5 MRM-005	350	620	250	1460	180	500

Ölçüler mm - *Measures in mm*
D43x1,2 mm



PASLANMAZ ÇELİK MERDİVENLER
STAINLESS STEEL LADDERS



Standart / Standard



AISI 304

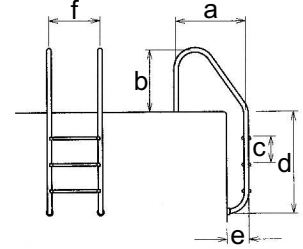

	Cod.	a	b	c	d	e	f	Kg	m ³
○ 2	87112926	664	610	250	696	200	500	10,0	0,06
○ 3	87112934	664	610	250	946	200	500	11,8	0,07
○ 4	87112942	664	610	250	1196	200	500	13,2	0,08
○ 5	87112959	664	610	250	1446	200	500	14,0	0,09



Muro / Muro

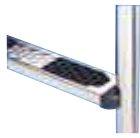

AISI 304

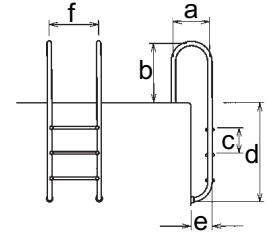

	Cod.	a	b	c	d	e	f	Kg	m ³
○ 2	87132023	357	610	250	696	200	500	10,0	0,06
○ 4	87132049	357	610	250	1196	200	500	13,2	0,08
○ 5	87132056	357	610	250	1446	200	500	14,0	0,09



Mixta / Mixta (Parallel-Look)



AISI 304

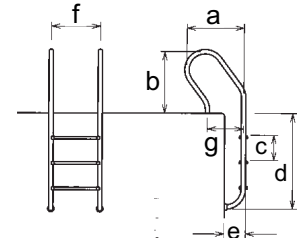

	Cod.	a	b	c	d	e	f	g	Kg	m ³
○ 2	87120861	561	610	250	696	200	500	357	10,0	0,06
○ 3	87120879	561	610	250	946	200	500	357	11,8	0,07
○ 4	87120887	561	610	250	1196	200	500	357	13,2	0,08
○ 5	87120895	561	610	250	1446	200	500	357	14,0	0,09



PASLANMAZ ÇELİK MERDİVENLER
STAINLESS STEEL LADDERS



Standart / Standard

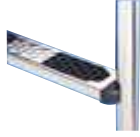

AISI 304

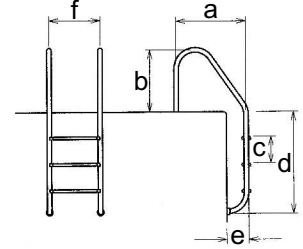

	Cod.	a	b	c	d	e	f	Kg	m ³
○ 2	87112926	664	610	250	696	200	500	10,0	0,06
○ 3	87112934	664	610	250	946	200	500	11,8	0,07
○ 4	87112942	664	610	250	1196	200	500	13,2	0,08
○ 5	87112959	664	610	250	1446	200	500	14,0	0,09



Muro / Muro

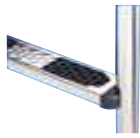

AISI 304

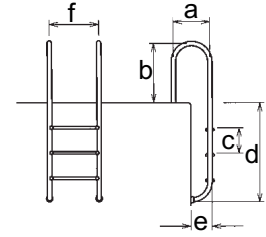

	Cod.	a	b	c	d	e	f	Kg	m ³
○ 2	87132023	357	610	250	696	200	500	10,0	0,06
○ 4	87132049	357	610	250	1196	200	500	13,2	0,08
○ 5	87132056	357	610	250	1446	200	500	14,0	0,09



Mixta / Mixta (Parallel-Look)



AISI 304

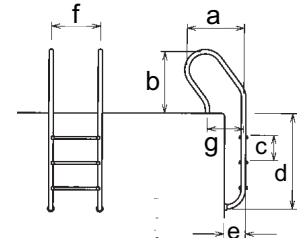

	Cod.	a	b	c	d	e	f	g	Kg	m ³
○ 2	87120861	561	610	250	696	200	500	357	10,0	0,06
○ 3	87120879	561	610	250	946	200	500	357	11,8	0,07
○ 4	87120887	561	610	250	1196	200	500	357	13,2	0,08
○ 5	87120895	561	610	250	1446	200	500	357	14,0	0,09



PASLANMAZ ÇELİK MERDİVENLER
STAINLESS STEEL LADDERS



Üstten taşmalı / *Overflow*

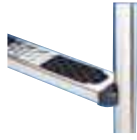

AISI 304

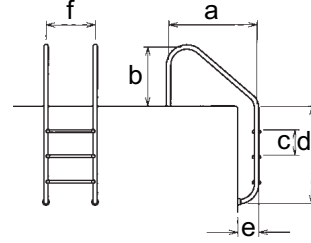

Cod.	a	b	c	d	e	f	Kg	m ³
5 87110896	957	610	250	1446	200	500	15,0	0,21



Özel üstten taşmalı / *Special Overflow*

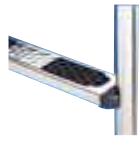

AISI 304

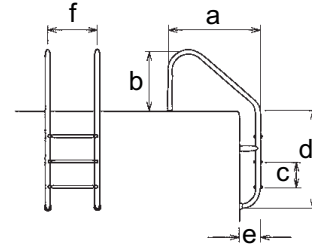

Cod.	a	b	c	d	e	f	Kg	m ³
4 87111840	957	610	250	1196	200	500	14,4	0,18



Özel üstten taşmalı / *Special Overflow*



AISI 316

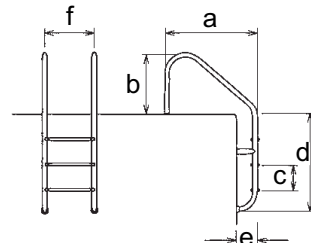

Cod.	a	b	c	d	e	f	Kg	m ³
3 87111831	957	610	250	946	200	500	12,4	0,14



PASLANMAZ ÇELİK MERDİVENLER
STAINLESS STEEL LADDERS



Üstten taşmalı / *Overflow*

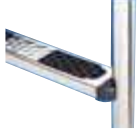

AISI 304

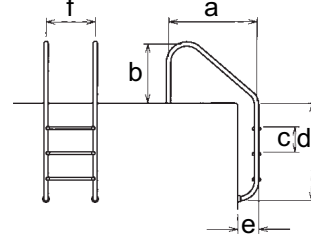

Cod.	a	b	c	d	e	f	Kg	m ³
5 87110896	957	610	250	1446	200	500	15,0	0,21



Özel üstten taşmalı / *Special Overflow*

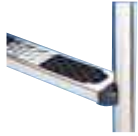

AISI 304

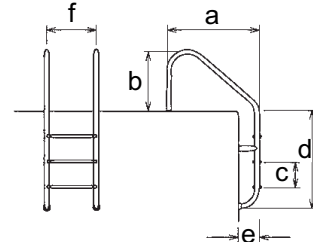

Cod.	a	b	c	d	e	f	Kg	m ³
4 87111840	957	610	250	1196	200	500	14,4	0,18



Özel üstten taşmalı / *Special Overflow*

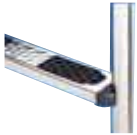

AISI 316

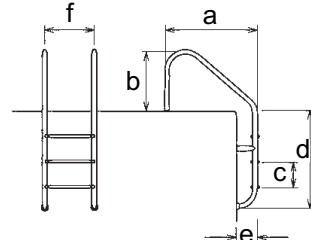

Cod.	a	b	c	d	e	f	Kg	m ³
3 87111831	957	610	250	946	200	500	12,4	0,14



PASLANMAZ ÇELİK TUTAMAKLAR STAINLESS STEEL HANDRAILS

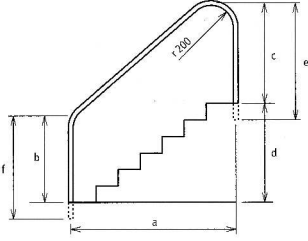

2 Kıvrımlı tutamak / 2-Bend handrail

Gömmeli
To be built-in
Cod.

Cod.	a	b	c	d	e	f	Kg	m ³
87162269	1829	752	817	1169	885	820	4,9	0,25

Flaş kaynaklı
Welded flange

Cod.	a	b	c	d	e	f	Kg	m ³
87162240	1219	752	817	660	885	820	4	0,14
87162250	1524	752	817	915	885	820	4,5	0,16

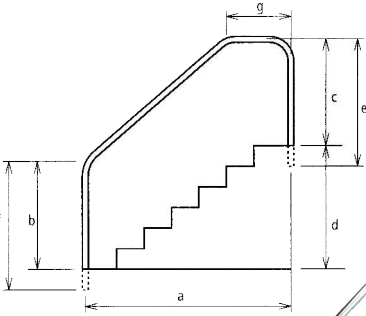

3 Kıvrımlı tutamak / 3-Bend handrail

Flaş kaynaklı
Welded flange

Cod.	a	b	c	d	e	f	Kg	m ³
87162361	1829	752	817	1169	-	-	5	0,36



Gömmeli
To be built-in
Cod.

Cod.	a	b	c	d	Kg	m ³
87168019	872	203	1219	940	4,5	0,05

